

THE COUNTY OF CARMARTHENSHIRE (CARMARTHEN) (WAITING RESTRICTION AND STREET PARKING PLACES) CONSOLIDATION (VARIATION No. 2) ORDER 2004

The Carmarthenshire County Council in exercise of their powers under Section 1(1), 2(1) to (3), 4(2), 32, 35 and 124 of and Part IV of Schedule 9 to the Road Traffic Regulation Act 1984 (which said Act is hereinafter referred to as "the Act of 1984") as amended by the Road Traffic Act 1991 and of all other powers them enabling and after consultation with the Chief Officer of Police in accordance with Part III of Schedule 9 to the Act of 1984 and with the Road Traffic Act 1991, hereby make the following Order:-

1. The County of Carmarthenshire (Carmarthen) (Waiting Restriction And Street Parking Places) Consolidation Order 2004 ("the Consolidation Order") is hereby varied by the attachment thereto of the plans attached to this Order which has the effect of imposing on such parts of the road identified and for the periods identified in the plans attached to this Order:

- (a) prohibition of waiting at any time
- (b) prohibition of waiting at any time with no exemption for loading and unloading of vehicles or for passengers to board and alight from a vehicle, or for the parking of disabled persons
- (c) prohibition of waiting between the hours of 9.00 a.m. and 5.00 p.m. on any day except Sunday for a longer period than one hour, or if a period of less then two hours has elapsed since the termination during the said hours of the last period of waiting (if any) by that vehicle on the same side of road
- (d) prohibition of waiting between the hours of 8.00 a.m. and 6.00 p.m. on any day except Sunday for a longer period than thirty minutes, or if a period of less than one hour has elapsed since the termination during the said hours of the last period of waiting (if any) by that vehicle on the same side of road

- (e) prohibition of parking between the hours of 8.00 a.m. and 6.00 p.m. on day except Sunday except for goods vehicles
 - (f) prohibition of parking except for disabled persons
 - (g) limited waiting to one hour for disabled persons
 - (h) exemption for the loading and unloading of goods
- in accordance with the provisions of the Consolidation Order.

2. The Order shall come into operation on the 22nd day of October Two Thousand and Four and may be cited as The County of Carmarthenshire (Carmarthen) (Waiting Restriction And Street Parking Places) Consolidation (Variation No.1) Order 2004

**THE COMMON SEAL of CARMARTHENSHIRE
COUNTY COUNCIL** was hereunto affixed
the 13th day October 2004

Before me,



Head of Administration and Law



SCHEDULE 1

Prohibition of Waiting at Any Time

Name of Road

King Street

Side of Road

On the South side:

From a point 44 metres south west of its junction with Church Lane for a distance of approximately 30 metres in a south westerly direction.

From a point 100 metres south west of the centre of its junction with Church Lane for a distance of approximately 30 metres in a south westerly direction.

SCHEDULE 2

Prohibition of Waiting at any Time with No Exemptions

Name of Road

Dark Gate Street

Side of Road

On the North Side:

From its junction with Blue Street for a distance of approximately 54 metres in a general westerly direction.

On the South Side:

From its junction with Blue Street for a distance of approximately 24 metres in a general westerly direction.

From a point 40 metres west of its junction with Blue Street for a distance of approximately 12 metres in a general westerly direction.

SCHEDULE 3

Waiting Limited to 1 Hour, Return Prohibited Within 2 Hours

9.00 a.m to 5.00 p.m. Monday to Saturday

Name of Road

Priory Street

Side of Road

On the North West side:

From a point 85 metres north-east of its junction with St. Peter's Street for a distance of approximately 30 metres in a north-easterly direction.

From a point 20 metres south west of the centre of its junction with The Avenue for a distance of approximately 18 metres in a north-easterly direction.

On the South East side:

From a point 15 metres north east of the centre of its junction with Penuel Street for a distance of approximately 39 metres in a north-easterly direction.

On the South East side:

From a point 10 metres south west of the centre of its junction with Furnace Bank for a distance of approximately 58 metres in a south-westerly direction.

SCHEDULE 4

Waiting Limited to 30 Minutes, Return Prohibited within 1 Hour

8.00 a.m. to 6.00 p.m. Monday to Saturday

Name of Road

Side of Road

Lammas Street

On the South side:

From a point 50 metres west of the centre of its junction with Lammas Street Car Park for a distance of approximately 24 metres in a general westerly direction.

SCHEDULE 5

Waiting Prohibited between the Hours of 8.00 a.m. and 6.00 p.m.

except for Goods Vehicles

Monday to Saturday

Name of Road

Side of Road

Spilman Street

On the North West side

From a point north east of the centre of its junction with Queen Street for a distance of approximately 32 metres in a north easterly direction.

From a point 123 metres north east of the centre of its junction with Queen Street for distance of approximately 12 metres in a north easterly direction.

SCHEDULE 6

Disabled Parking Bays

Name of Road

Side of Road

King Street

On the North West side:

From a point 140 metres north east of its junction with Queen Street for a distance of approximately 21 metres in a north easterly direction.

SCHEDULE 7

Loading and Unloading of Goods

Name of Road	Side of Road
Priory Street	<p><u>On the North-western side:</u> From the northeastern kerbline of its junction with the access road to Priory Street Car Park in a northeasterly direction for a distance of approximately 59 metres. From the southwestern kerbline of its junction with Old Oak Lane in a southwesterly direction for a distance of approximately 30 metres.</p> <p><u>On the South-eastern side:</u> From the southwestern kerbline of its junction with Old Priory Road in a southwesterly direction to a point approximately 43 metres southwest of the southwestern kerbline of its junction with Old Oak Lane</p>

SCHEDULE 8

Revocation of Prohibition of Waiting at any time

Name of Road	Side of Road
Priory Street	<p><u>On the North-west side:</u> From a point 15 metres north east of the centre of its junction with Priory Street for a distance of approximately 125 metres in a north-easterly direction. From a point 12 metres south west of the centre of its junction with Reservoir Road for a distance of approximately 135 metres in a south-westerly direction.</p> <p><u>On the South-east side:</u> From a point 55 metres north east of the centre of its junction with Furnace Bank for a distance of approximately 13</p>

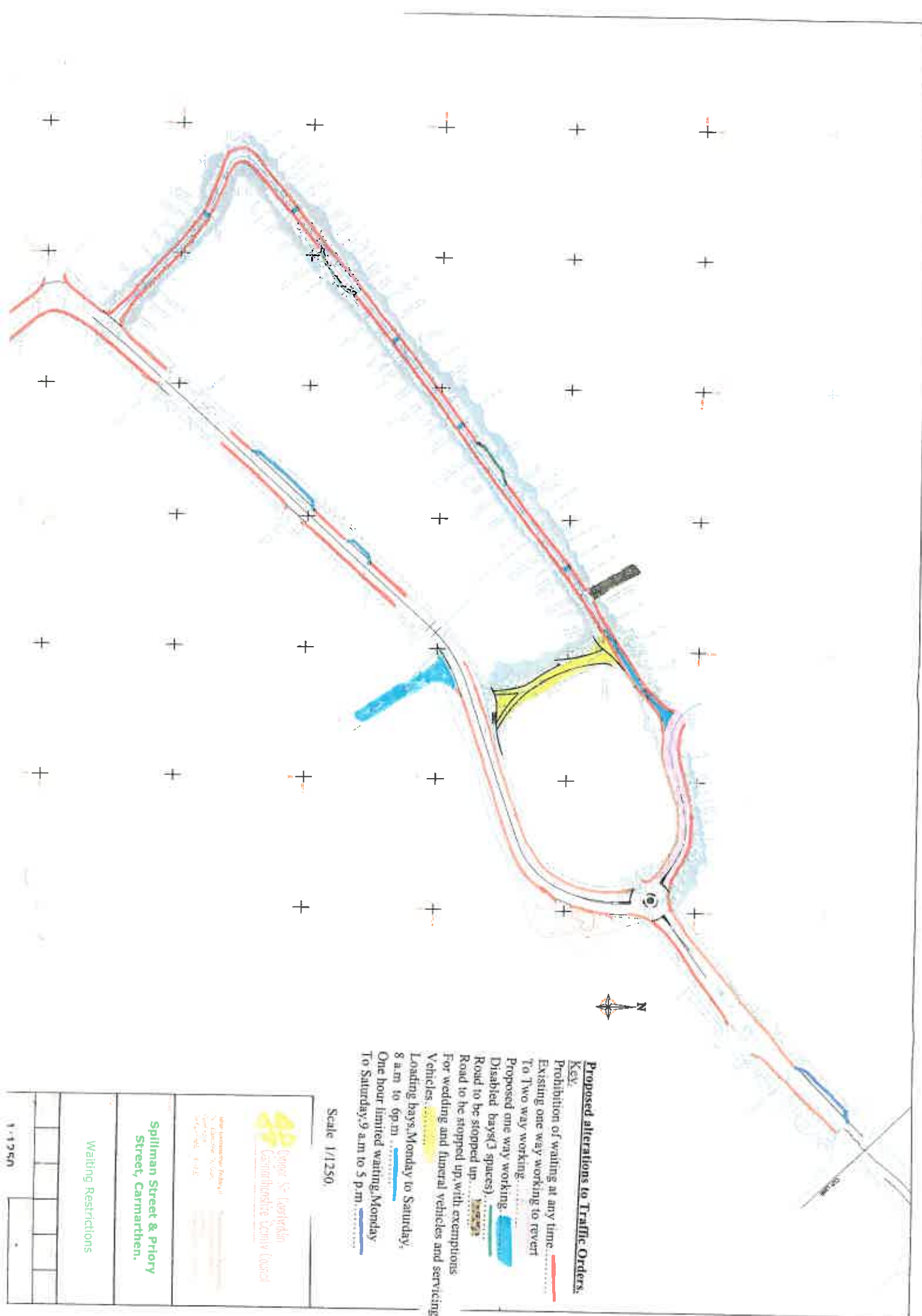

Proposed alterations to Traffic Orders:

- Key:**
- Prohibition of waiting at any time: ———
 - Existing one way working to revert to Two way working: ———
 - Proposed one way working: ———
 - Disabled bays(3 spaces): ———
 - Road to be stopped up: ———
 - For wedding and funeral vehicles and servicing Vehicles: ———
 - Loading bays, Monday to Saturday, 8 am to 6p.m: ———
 - One hour limited waiting, Monday To Saturday, 9 am to 5 p.m: ———

Scale 1/1250.

Cyngor Sŵ Caerffili
Carmarthenshire County Council

Yn parhysu'r Ffôn
Cyffwrdd 10.30
Mawrth, 2012

Spillman Street & Priory Street, Carmarthen.

Waiting Restrictions

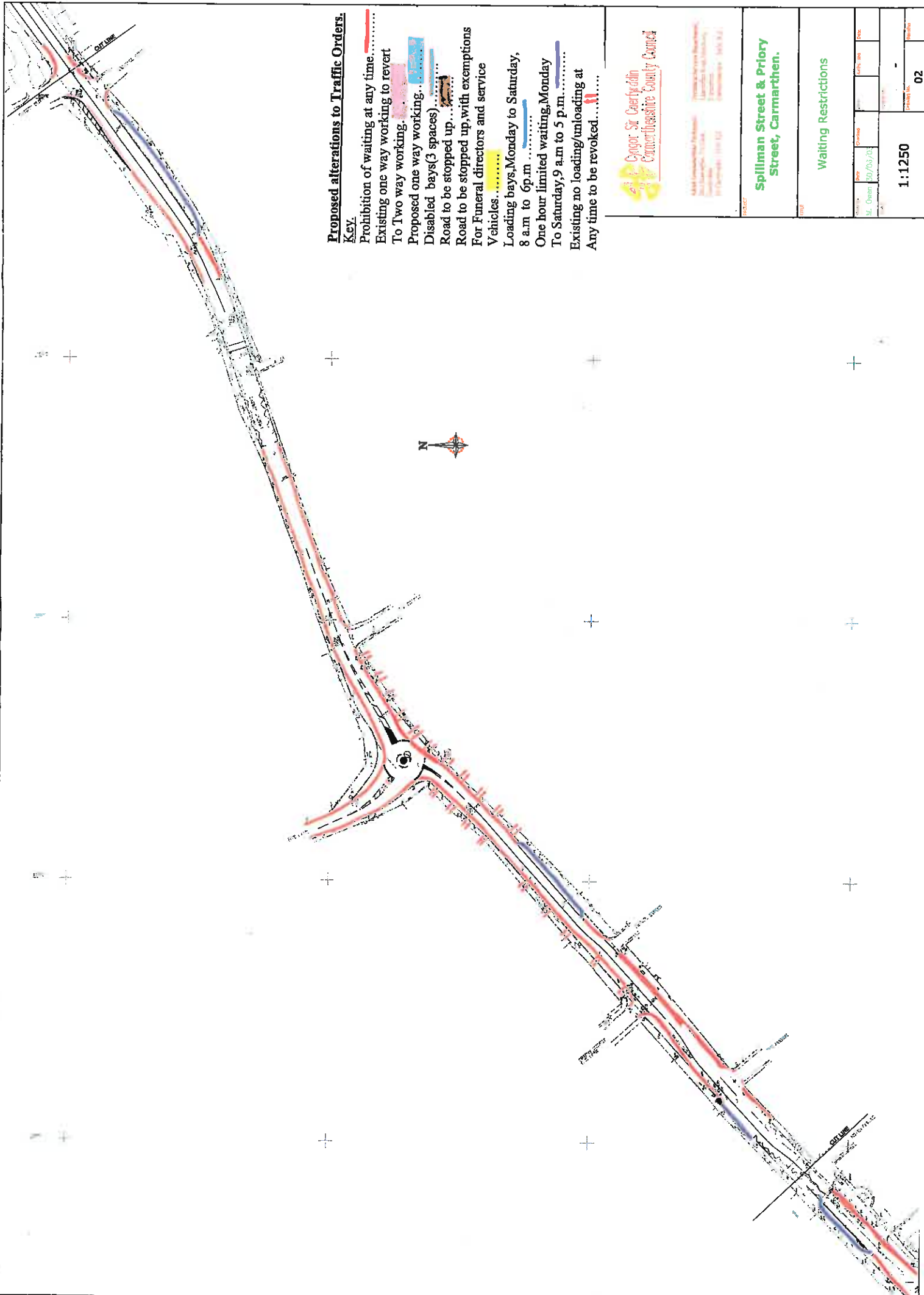

Proposed alterations to Traffic Orders.

- KEY.**
 Prohibition of waiting at any time.....
 Existing one way working to revert To Two way working.....
 Proposed one way working.....
 Disabled bays(3 spaces).....
 Road to be stopped up.....
 Road to be stopped up, with exemptions For Funeral directors and service Vehicles.....
 Loading bays, Monday to Saturday, 8 a.m to 6p.m.....
 One hour limited waiting, Monday To Saturday, 9 a.m to 5 p.m.....
 Existing no loading/unloading at Any time to be revoked.....



01920 303030
 01920 303030
 01920 303030
 01920 303030
 01920 303030

Spillman Street & Priory Street, Carmarthen.

Waiting Restrictions

Map No.	Scale	Author	Checked	Approved	Date
M. Owen	1:1250				
1:1250					02

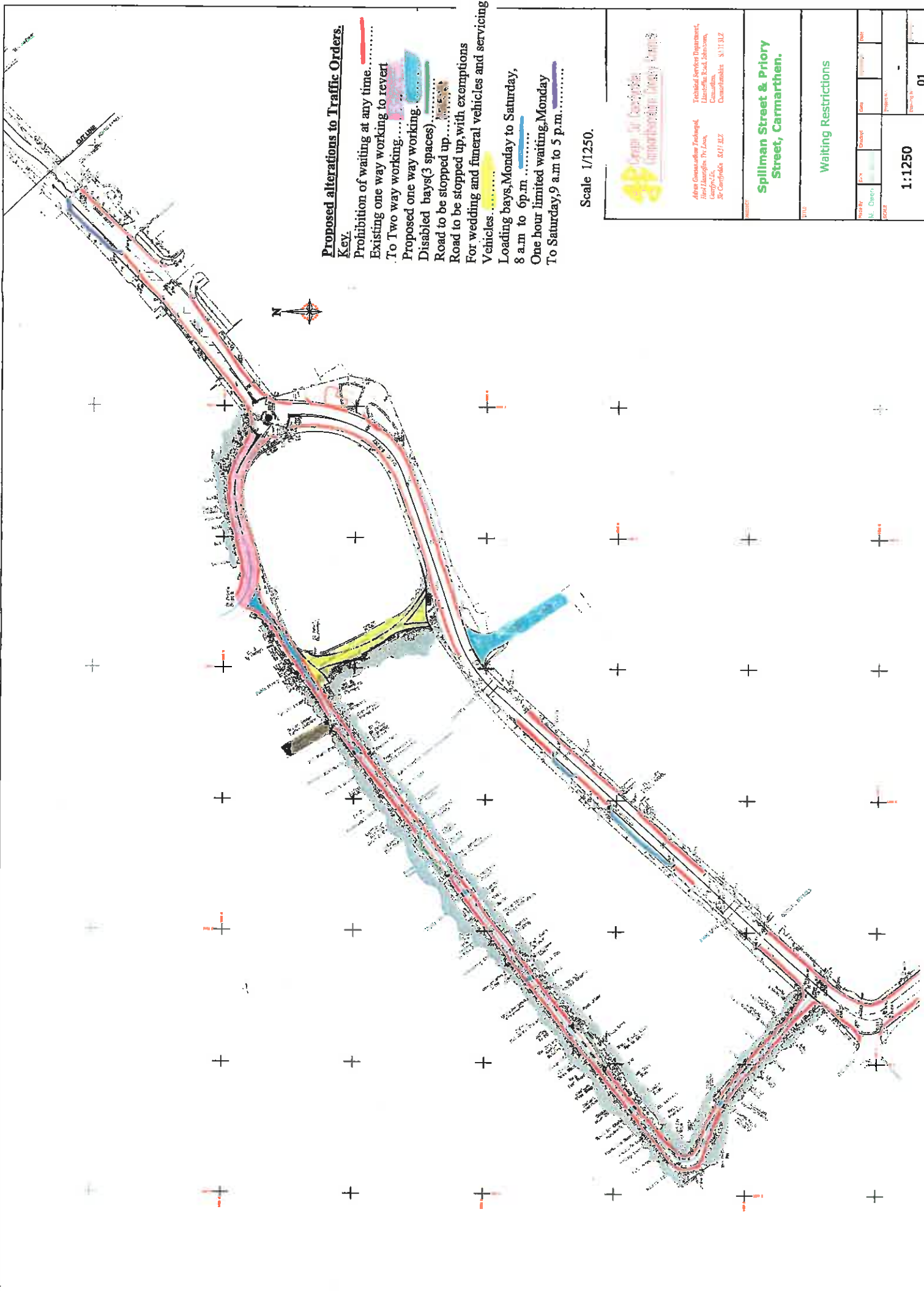

Proposed alterations to Traffic Orders.

- Key.**
- Prohibition of waiting at any time.
 - Existing one way working to revert To Two way working.
 - Proposed one way working.
 - Disabled bays(3 spaces)
 - Road to be stopped up.
 - For wedding and funeral vehicles and servicing Vehicles.
 - Loading bays, Monday to Saturday, 8 a.m to 6p.m.
 - One hour limited waiting, Monday To Saturday, 9 a.m to 5 p.m.

Scale 1/1250.

		Technical Services Department, Llanswili Road, Johnstown, Carmarthen, SA31 3LZ Carmarthenshire SA31 3LZ	
Spillman Street & Priory Street, Carmarthen.			
Waiting Restrictions			
Drawn By N. Owen	Checked By []	Date []	Project No. []
1:1250		01	